

REGLES DE BASE POUR LE DESIGN DES COMPOSANTS A METALLISER

SOUDURES ET BORDS

- Des soudures continu
- De préférence faire les soudures avant métallisation, si après-> masquage à 100 mm
- Arrondir les bords
- Bords coupés au laser: rugosité – arrondir – bavures

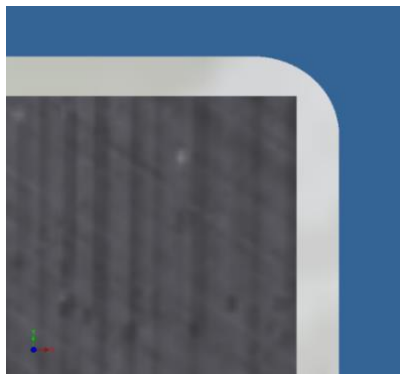

mauvais

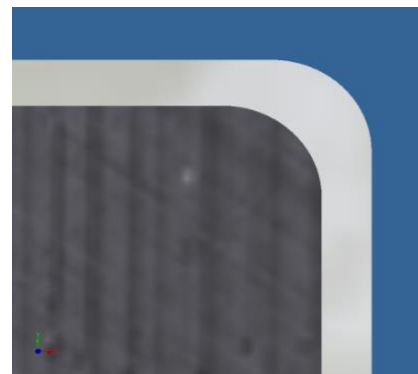

bon

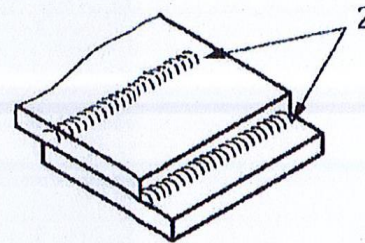
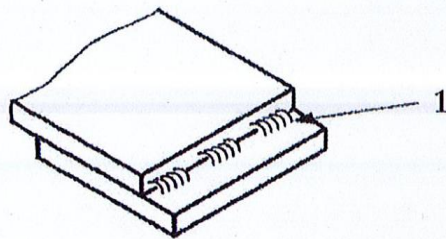
REGLES DE BASE POUR LE DESIGN DES COMPOSANTS A METALLISER**SOUDURES ET BORDS**

mauvais

bon

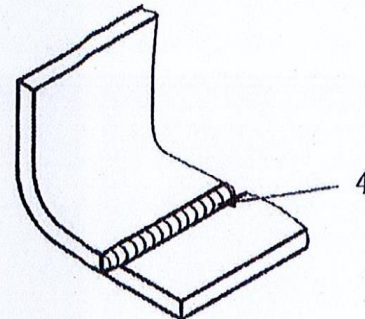
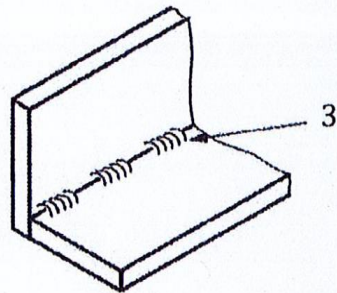

- 1 Overlapping joints with discontinuous welds are to be avoided.
- 2 Overlapping fully sealed by continuous welds, smooth and free from slag and weld spatter are to be preferred.
- 3 Sharp corners and discontinuous welds are to be avoided.
- 4 Rounded corners and continuous butt welds are to be preferred.